



6 Church Street

Ince, Wigan, WN3 4RF

£795 PCM



Sapphire Homes are delighted to offer For Rent this well maintained 2 bedroom mid terraced property that is located in a popular residential location and is close to Wigan town centre, local schools and amenities as well as being a short walk from Ince Train Station for those requiring commuter links. The property briefly comprises of entrance / vestibule, lounge and to the rear elevation is a fitted kitchen / diner with understairs storage and door leading to the rear garden. To the first floor the landing provides access to 2 good sized bedrooms and a family bathroom with modern three piece suite in white with shower over bath. The property is warmed by Gas Central Heating and benefits from a tasteful décor and double glazing throughout. To the front of the property is a small garden area with brick perimeter wall and gate. To the rear there is a low maintenance garden with patio area and rear gated access. The property would suit professional, couple or small family and early internal viewings are highly recommended to appreciate in full. No Smoking



GROUND FLOOR

Entrance / Vestibule

Lounge

Kitchen / Diner

FIRST FLOOR

Landing

Bedroom 1

Bedroom 2

Bathroom

EXTERNAL

Rear Garden

Area Map

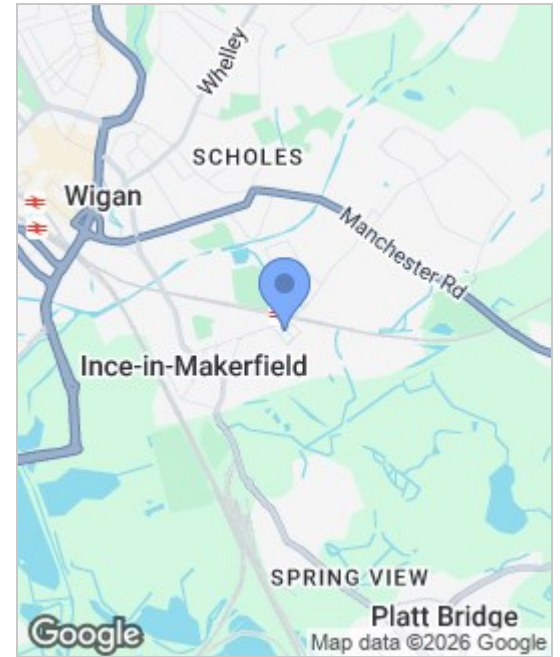

Floor Plans

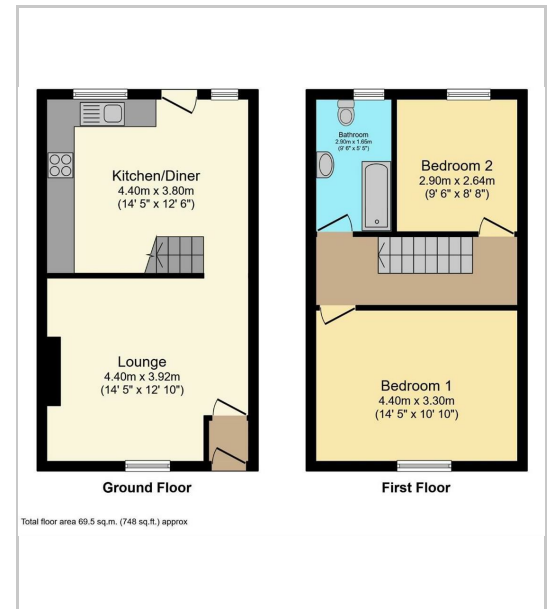

Energy Efficiency Graph

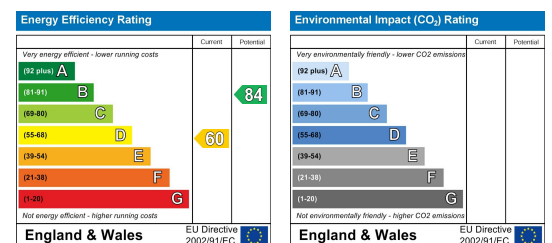

These particulars, whilst believed to be accurate are set out as a general outline only for guidance and do not constitute any part of an offer or contract. Intending purchasers should not rely on the representation of fact, but must satisfy themselves by inspection or otherwise as to their accuracy. No person in this firm's employment has the authority to make or give any representation or warranty in relation to the property.



Sapphire Homes (North) Ltd 80 Market Street, Wigan WNI 1HX
 T 01942 494944 E info@sapphirehomes.co.uk W www.sapphirehomes.co.uk VAT 183 759 366

specialists in sales, Lettings & Property Investments